

PRODUCT SPECIFICATION

electronic foam-soap dispenser ONE copper KU-140E-FO

specification text

electronic foam-soap dispenser, series PROOX ONE
copper

dimensions: 118 x 320 x 120 mm

Electronic foam-soap dispenser with optical sensor.
Series PROOX ONE copper, PVD coated. For wall
mounting. Perforated fill level indicator with 4mm
drillings. Soap dispenser can be operated with battery
(4 x Alcaline 1.5V, AA) or optional with direct power
plug 230V. Filling bin with lid. 0.8 litres capacity. The
unit can be removed for cleaning purpose. Lock not
visible. Includes stainless steel screws and plugs.

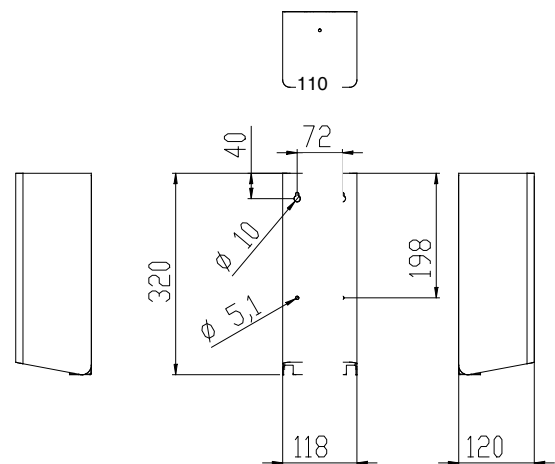

further product recommendations



paper towel dispenser
KU-100



waste bin
KU-200



double toilet roll holder
KU-300



toilet brush holder
KU-500



tissue dispenser
KU-390