

MediQo Stealth

user manual



Tel : 0333 335 0433



Definitions and symbols



WARNING! Not following the warning may result in death or serious injury



CAUTION!

Not following operating or maintenance procedure may result in personal injury or product damage



Strict Advice



No Wet Hand



No Disassembly



Not water to inside or outside the product



Prohibition



Not pour chemical agent or inflammables



No touch



Pull out the power supply cord from the outlet



Precautions: «WARNING»



WARNING means that a serious injury may be caused unless use as directed



WARNING (Electric Power) :



Plug in the power supply cord into a standardized outlet. Use a standardized cord and do not insert many plugs at a time



If the supply cord is damaged, it must be replaced by a special cord or assembly available from the manufacturer its service.



*Clean the power plug at all time and plug in the cord completely. Dust and incomplete plug of the cord may cause fire.



Be careful the power supply cord is not to be crushed at the back of the product. Place the product at least 10mm away from the wall.











Precautions: WARNING



WARNING means that a serious injury may be caused unless use as directed



WARNING (Handling and Maintenance) :

-  Do not open the front cover. An electric shock may be caused
-  Do not put anything on the product. An injury may be caused by a falling
-  Do not disassemble the product to repair by unauthorized personnel. An injury, an electric shock or fire may be caused.
-  Do not pour inflammables, such as ether, benzene, a chemical agent, alcohol, LP gas (butane and propane), etc., into the product. Risk of electric explosion and/or fire.
-  Mount the product far away from the heat of fire including an electric heater, candle light, etc. Risk of fire
-  Do not put any container filled with water, a vase, a cup, a chemical agent, etc., on the product. Risk of fire or electric shock and its fall may cause an injury or the damage of the product.
-  Do not pour water on the product.
-  Do not hang on the product. Take special care to small children that they do not hang on the product.









Precautions: CAUTION



CAUTION: Means that a slight injury may be caused or the product may be damaged, unless use as directed.



CAUTION:

-  Never touch the cord without Ne jamais toucher le fils without having the authorization of the service agent or any other authorized person.
-  Do not touch the power plug with wet hands. Risk of electrocution
-  Place and set up the product on a strong and straight wall. Setting up the product on uneven wall may cause its falling or vibration.
-  Do not put your hands inside the product at the bottom. An injury may be caused.
-  When cleaning or handling the product, be sure to turn the power switch off. Risk of electric shock or injury.
-  Do not pull the air filter out while it is being operated: the air purifier and the motor may not be working.



Components

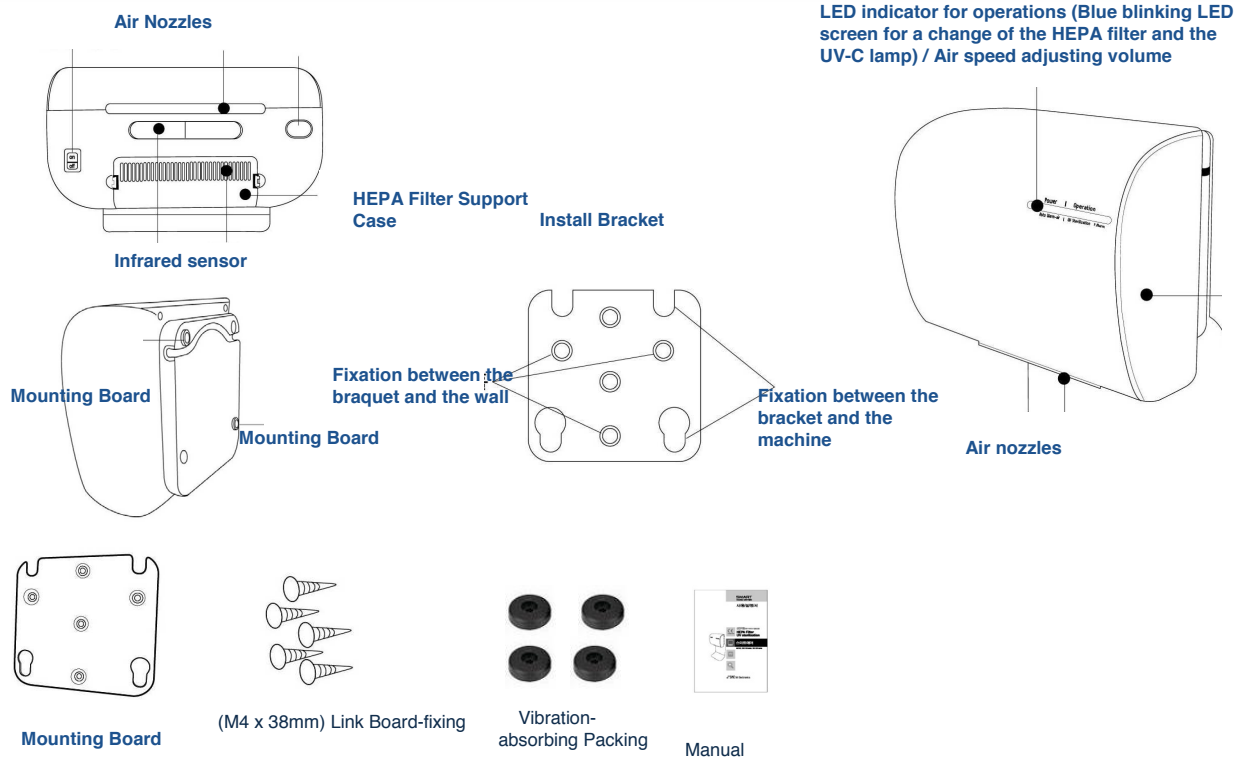

Specifications et Electric Requirements

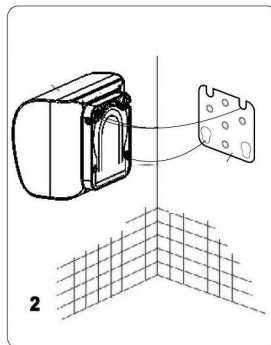
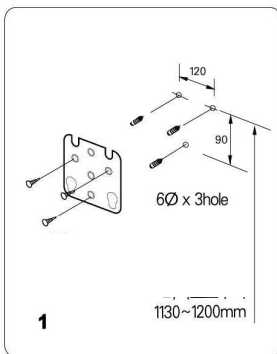

- Reference : Smart Air / SHD 100 / SHD 200 Series
- Voltage Supply : 230V
- Frequency 50~60 Hz
- Rated Power : 700 W-240 W (6A)
- Ingress Protection Ratio: Classe II / IPX33
- Hand Dry Time : 6 to 10 seconds
- Air Velocity : 540km/h / RPM 33,000rpm
- Cord : 1.8m
- Dimension : 254mm X 214mm X 163mm
- Weight : 3 Kg



- (1) Wire must follow the related standards. (A standardized wire must be used for interior wiring)
- (2) All electrical work have to be performed by a qualified electrician in strict compliance with local safety regulations
- (3) For safety and to prevent any incident, do not install the product in the following places:
 - Temperature above 40°C.
 - Exposed to direct rays or hard light and bumpy surface (the sensor may be damaged)
 - Exposed to corrosive gas
 - With a humidity level of more than 95%



1. Preparation before Installation

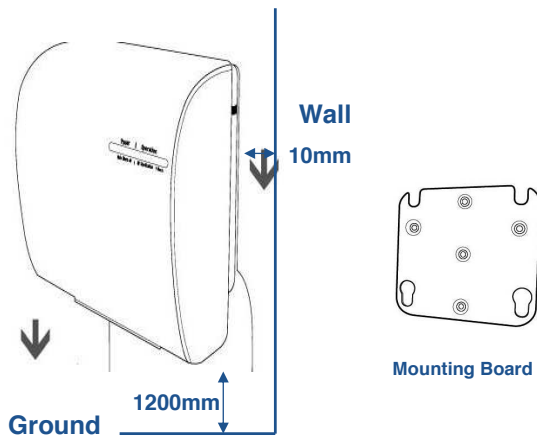

Installation Position:

- Place the product at about 1300mm from the ground
- Place the product at least 10mm from the wall (vibration-absorbing packing)
- Make sure the wall is strong and straight
- Place it away from the doorway or people bumping easily
- Recommended Installation Height :
 - Men = 1300mm
 - Women = 1100mm
 - Children = 700mm

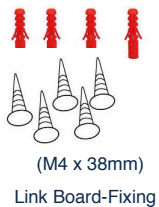

2. Installation of the Mounting Board

Etape 1. Positionner à l'endroit où vous souhaitez installer

- Drill three holes 55mm deep.
- Insert the anchors into the hole
- (1) Fit the vibration-absorbing packings and tighten the bracket with fixing screws.
- Place the product at about 1300mm from the ground
- Place the product at least 10mm from the wall
- On a concrete wall, use metal-screws
- Place the product on a strong and straight wall
- On a weak wall, make sure to reinforce enough the wall before setting up the product
- Place it away from the doorway or people bumping easily

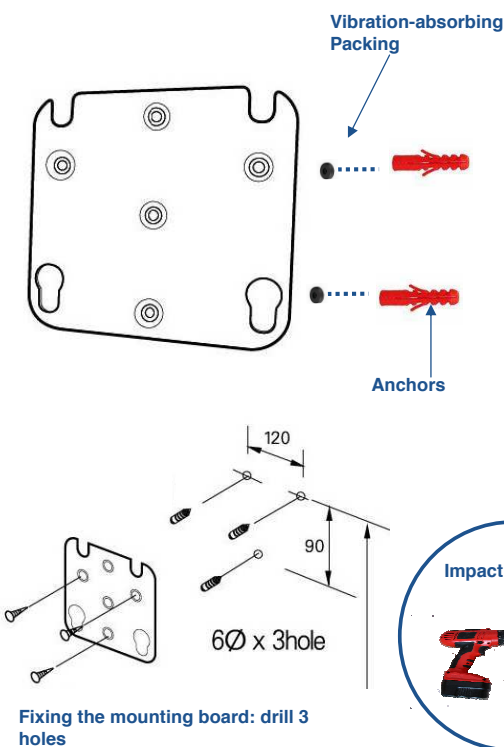



3. Installation of the hand dryer

1. Open the lid as shown below:

- (1) Remove the 2 screws located on the top and back of the machine
- (2) Remove the lid by pushing it slightly downwards

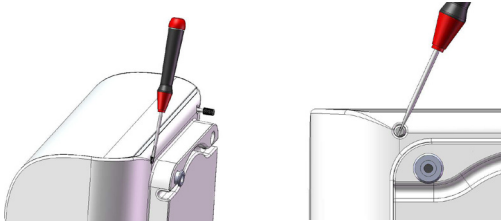

(3) Remove the electric wire from inside the machine

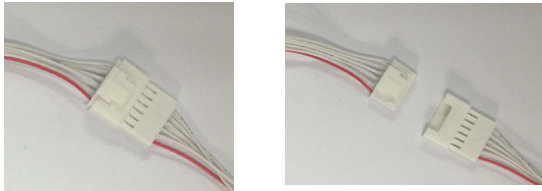

2. Putting up the product on the mounted bracket

- (1) Put the back body of the machine in the slots and fix the product by pushing it downwards

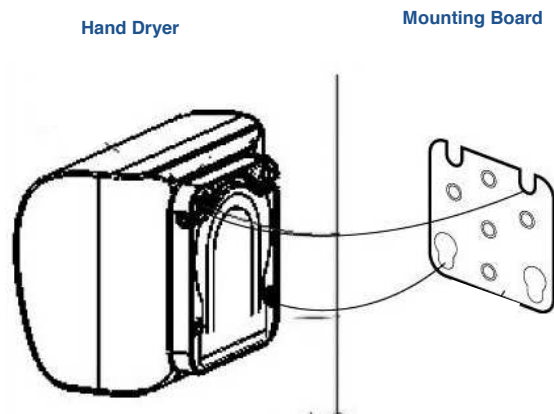

4. Ground wire connection

This device operates with an AC 230V (50Hz) supply

- (1) Remove the 2 screws, connect the machine respecting the internal wires colors
- (2) (Red : Phase, Blue : Neutral, Green-yellow : Ground), and firmly tighten the screws terminals connection

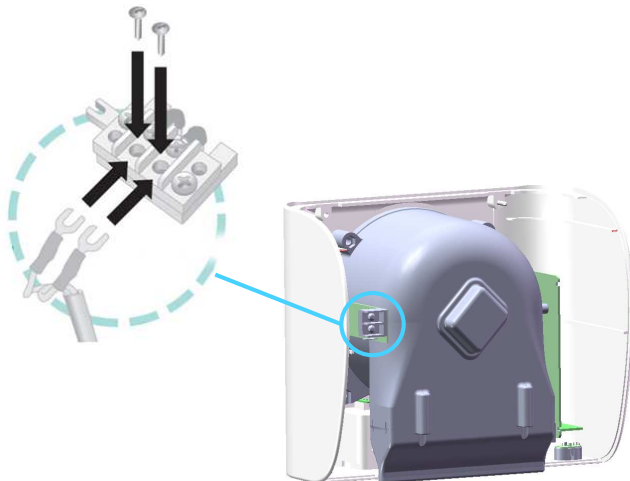

(3) Replace the lid in reverse order and tighten the 2 screws

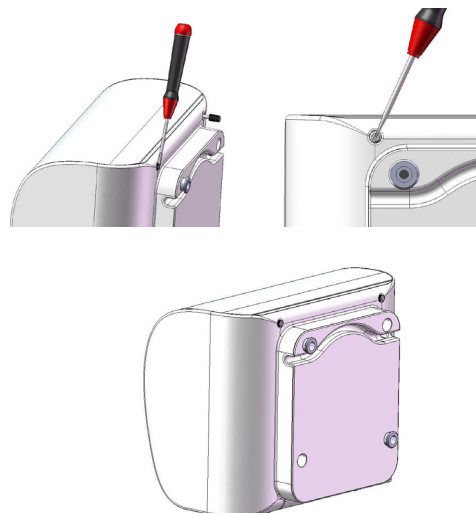



5. Test and Check Ups

After plug in the cord to a standardized outlet, check that it works

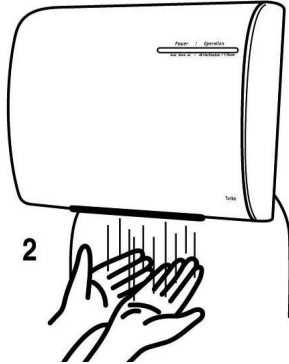

Dry your hand slowly to drain the water downward thanks to a powerful automatic sterilization of the air nozzles and HEPA filter that kills all bacteria before use.

After turning on the machine, check whether the power lamp turns on

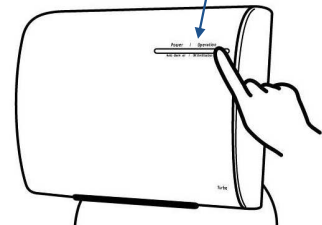

4 Speed Air Adjustment : Press down the button for 1 second as shown : Turbo / High / Normal / Quiet

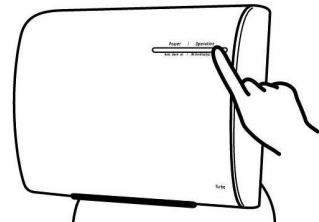

Indicator for changing the HEPA filter every 30 000 cycles / Indicator for changing the UV-C every 5 000 operating hours:

Blue blinking LED change indicator



Maintenance

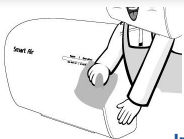

Infrared Sensor

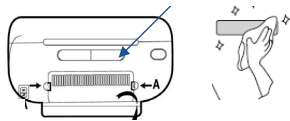

Slide the HEPA filter case to take it out

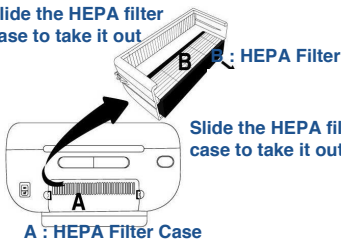

A : HEPA Filter Case



HEPA Filter support case

1. Use a soft towel with warm water or soft detergent. After using a neutral detergent, be sure to wipe it using a wet towel.
2. Use a soft towel with warm water or soft detergent to clean the infrared sensor. After using a neutral detergent, be sure to wipe it using a wet towel.



- Do not pour water directly on the product. An electric leak or a trouble may be caused.
- Do not use abrasive, oil, benzene, thinner, hydrochloric acid, hot water, rough brush, etc. Those materials may damage the surface or parts of the product.

2. Slide the HEPA filter support case to remove it. Pull out the HEPA filter and clean only the case. Install the filter back and insert the case into the main unit.



- Do not clean the HEPA filter. This could damage the motor.



Depending on the condition of the installed place, it needs to be replaced at least every 30 000 cycles. If not changed regularly it could damage the motor and the warranty will not be covered.



Warranty Policy

Model: SF01 Grey/SF02 White

Purchasing Date:

5 warranty or 700 000 cycles

Dealer:

Customer:

Tel:

Address:

Free repair can be provided only when the machine has troubles within 5 years after the purchasing date (warranty period)

In case of the following, you are charged with repairs:

- Troubles or damages caused by carelessness in use and improper repair or remodeling.
- Troubles or damages caused by act of vandalism, fire, earthquake, flood, abnormal climate conditions, incorrect power supply or other natural disasters.
- Troubles or damages from careless transportation or handling after purchase
- Trouble or damages caused by faulty or incorrect installation
- Troubles or damages caused by inadequate or incorrect maintenance
- Troubles or damages following maintenance or modifications carried out by a third party
- Troubles or damages from the use of foreign materials